

Eco Preparation 1600 mm Sink with 2 Bowls - Right drain

ITEM # _____

MODEL # _____

NAME # _____

SIS # _____

AIA # _____

132904 (SL216DN)

 Sink Unit with 2 bowls right-
hand drainer
500x500x250mm, 1600mm

Short Form Specification

Item No. _____

Worktop in 304 AISI stainless steel with front edge h=50mm.
 Rear upstand h=100mm. N.2 bowls 400x500x250h mm.
 Front and side covering panels in stainless steel. Rear panel
 in stainless steel. Square section legs 40x40mm in stainless
 steel with adjustable feet.

Main Features

- Sturdiness, stability and reliability of table accurately tested.

Construction

- Constructed entirely in stainless steel to offer maximum durability.
- Delivered in knock-down package.
- Wide range of taps are available to suit every need.
- Drainage area suitable for drying operations

Optional Accessories

- Lower shelf for 1600mm tables PNC 855147 ☐ and sinks
- Set of 4 wheels (2 with brake) PNC 855150 ☐ d. 100mm for tables and sinks (total height on wheels= 993 mm)
- 3-sided underframe for PNC 855154 ☐ 1600mm tables
- Single plastic drain syphon 1,5 PNC 855306 ☐ " for work tables with bowl
- Elbow operated mixer tap with PNC 855322 ☐ spout 3/4", single hole
- Elbow operated mixer tap with PNC 855323 ☐ short spout 3/4", single hole
- Foot operated mixer tap (hot PNC 855328 ☐ and cold) with spout 3/4"

APPROVAL: _____

Front

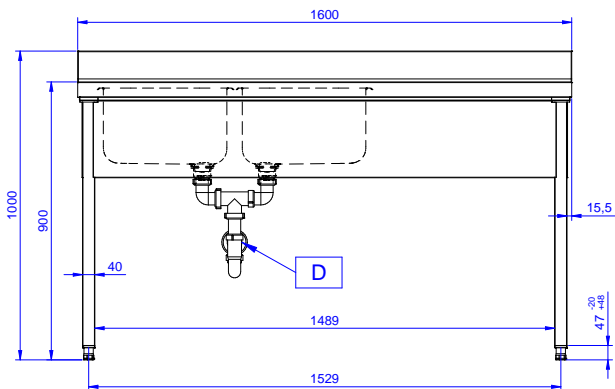

Side

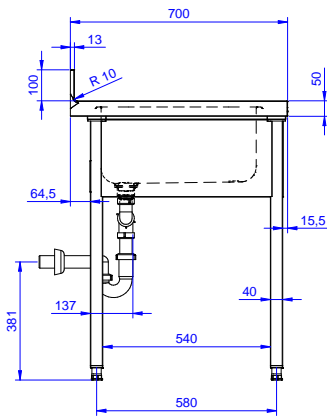

D = Drain

Top

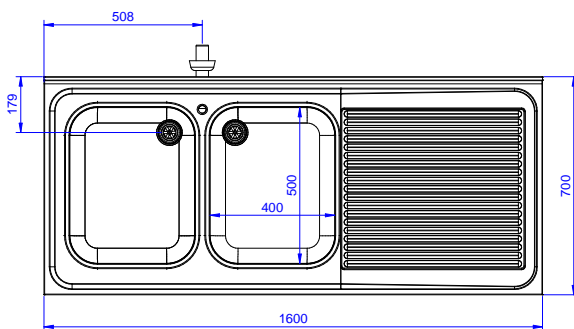

Key Information:

External dimensions, Width:	1600 mm
132904 (SL216DN)	
External dimensions, Depth:	700 mm
External dimensions, Height:	900 mm
Upstand Dimensions, Height:	100 mm
Upstand Dimensions, Depth:	13 mm
Upstand Dimensions, Radius:	R=10
Bowls number	2
Bowl dimensions	400X500XH250
Net weight:	48 kg